

# Miniland Building: MINILAND Character Build

## Extended GuideLines Part II - The Body

By Didier Enjary

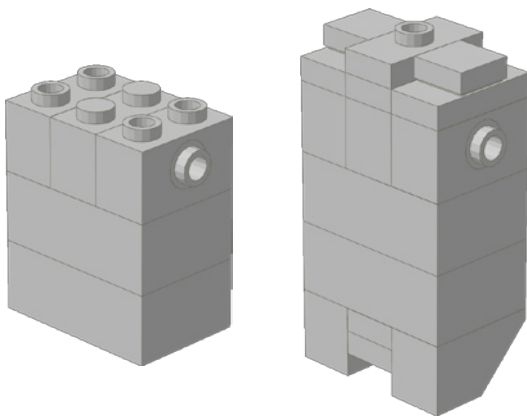

The torso is the central part of MINILAND characters. We will first consider it as a parallelepiped of 2x3 studs on 3 bricks high. For the sake of clarity for the rest of the presentation, we will add connections for the arms (half-Technic pins), the junction with the head (jumper plate) and the upper legs (the inverted slope bricks). In the forthcoming articles, other possibilities will be described in regard to these particular elements. All dimensions can be adapted to represent children, teenagers or overweight people.

The first amendments to this uniform and geometric bust that we will expose concern the patterns that can be done to add details. The simplest is to add a belt with its buckle. On that purpose, we use plates of different colors from the rest of the torso and legs. As we will see later, it often needs a change on part colors to suggest a new item. A similar change consist in swapping the color all the way up to the neck. We then get an open jacket over a T-shirt.

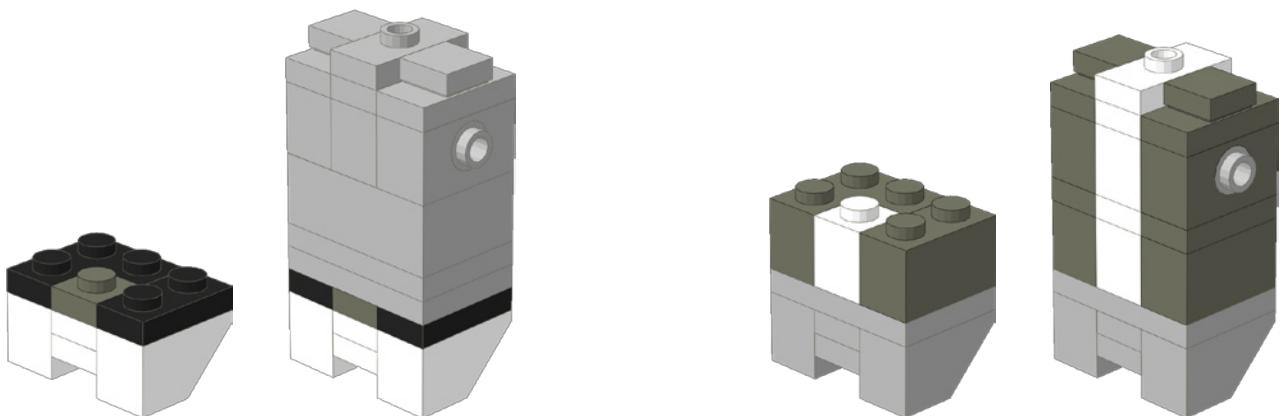

The following examples show that by varying the colors, you can already get a huge variety of different characters.

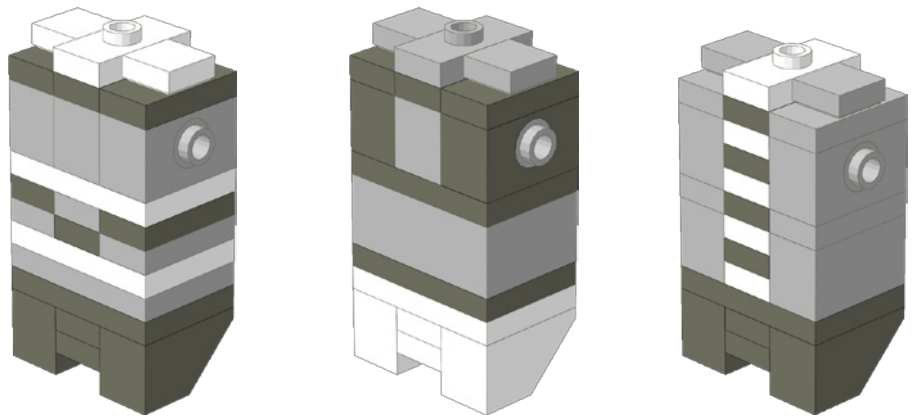

A minor change - the addition of a 1x1 Technic bricks with half pin or of an Erling's brick - allows you to add details like a tie or shirt pockets.

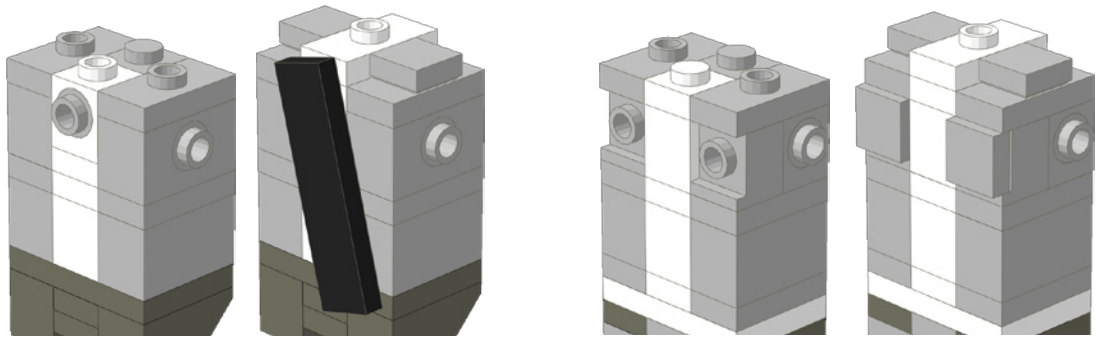

The same change made possible to put a smooth plate 1x2. This assembly is used for female characters to represent the chest.

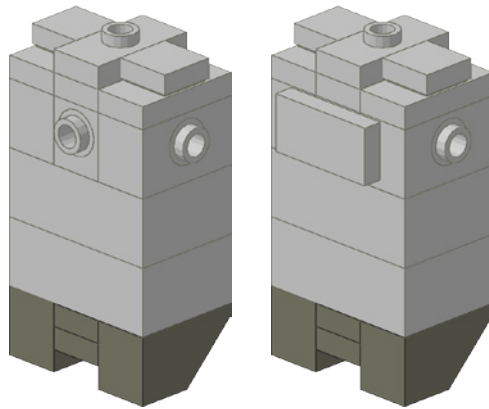

Keeping in mind the will to represent women, the following arrangement makes an intensive use of the jumper plate to shape a thinner figure at the waist.

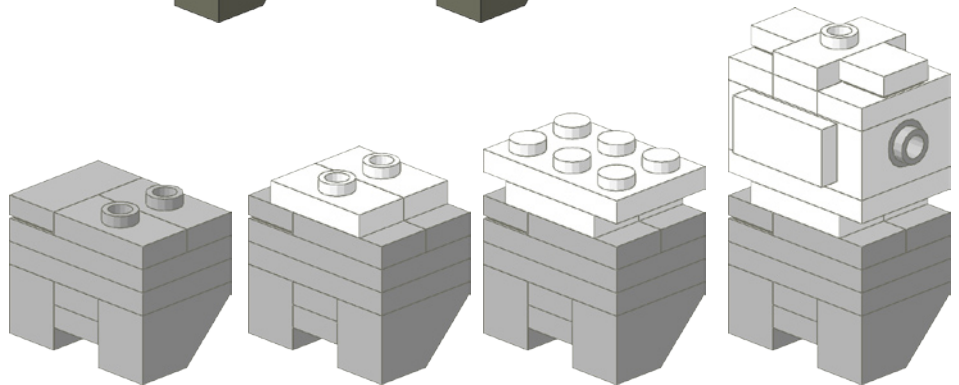



### Body

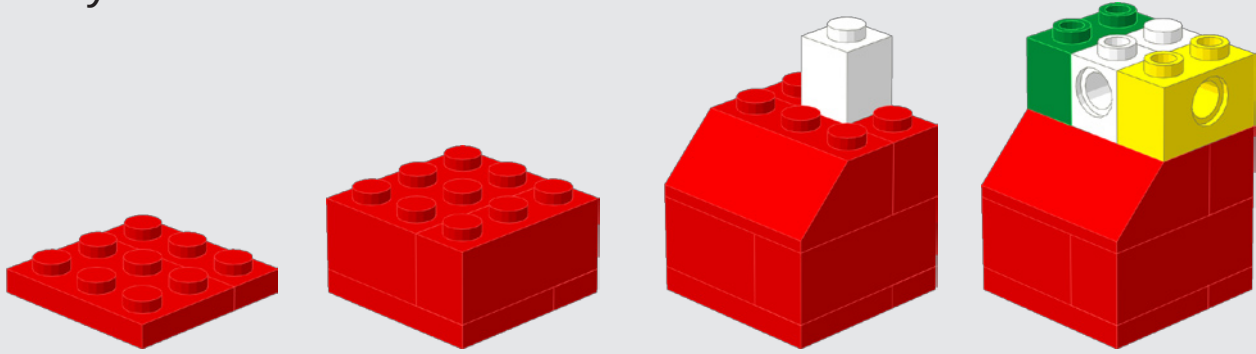

### Head

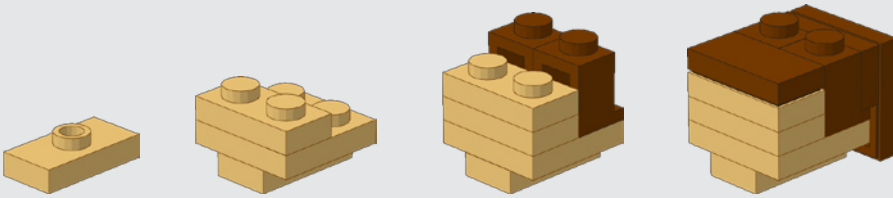

### Right Arm

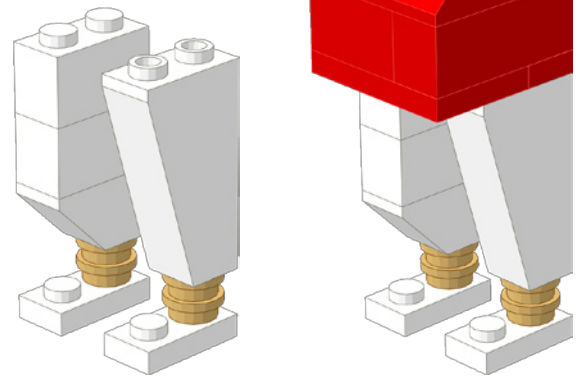
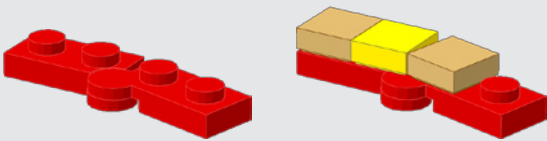

### Left Arm

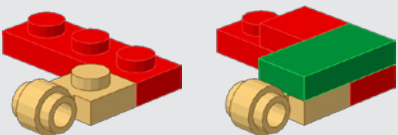

### Left leg

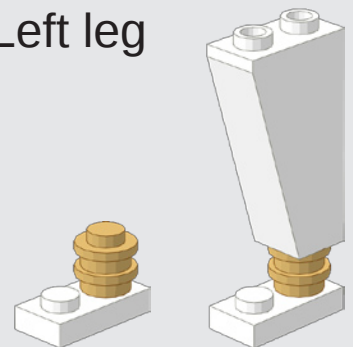



Arts created using  
the LDraw  
System of Tools

Original Design  
from Billund's  
MINILAND Model

